

BEFORE STARTING ASSEMBLY MAKE SURE ALL COMPONENTS LISTED ARE IN THE PACKAGE

Important safety instructions

All of the safety and operating instructions should be read, adhere to and followed before the unit is operated.

1.Precaution Before Installation

- **Warnings**
- **Caution**
- **Operating Instruction**
- **Care and Maintenance**
- **Warranty**

2.Installation

- **Included Components**
- **Tooling Required**
- **Electrical Info**
- **Parameter**
- **Installation Diagram**

3.Usage Attention

- **Usage Display**

TRADITIONAL T-2536

INSTALLATION INSTRUCTIONS



WARNINGS

PLEASE READ THE FOLLOWING INFORMATION BEFORE INSTALLING AND USING YOUR HEATED TOWEL RACK.

- These units should be installed by a certified electrician in accordance with the National Electrical Code [NEC] and the Canadian Electrical Code [CEC].
- The unit requires a 120 volt, 60Hz power source and should be installed on a GFCI protected circuit.
- Plug-in units should be connected to a grounded outlet with a minimum rating of 10 amps.
- Follow installation instructions to ensure unit is securely fixed to wall. Unit is designed for drying towels. Under no circumstances should anybody climb on or hang on unit.
- Unit is intended for indoor use only. Do not place units inside a shower, sauna, steam room, or wherever unit would be exposed to water.
- To reduce the risk of electric shock, burns, fire or injury.
- Close supervision is necessary when this unit is used near children or disabled persons.
- Use this unit only for its intended use as described in this manual.
- Do not use outdoors.
- Do not alter the safety plug or use an extension cord with this device.
- Do not operate with a voltage converter.
- Do not touch hot surfaces.
- Do not use accessory attachments not recommended by the manufacturer as this may cause injuries.

CAUTION

- As this is a heating device, the surface temperature can increase depending on the ambient temperature in the room and the number of towels applied to the unit.
- Overloading the unit will cause the unit to become extremely hot and may result in a burn if touched and/or damage to towels.
- The fasteners provided with the installation kit are for convenience only and are not suitable for all installation conditions.
- It is the ultimate responsibility of the installer to ensure proper mounting hardware is employed in attaching the unit to the wall.

OPERATING INSTRUCTION

- After installation, connect the electric power.
- Turn on the wall switch and towel warmer will start to heat-Allow 10-20 minutes to heat up.
- This towel warmer has been designed to run continuously-wall switch when the towel warmer is not in use for long periods of time.

CARE & MAINTENANCE

- Towels which contain soap or detergent residue may appear to have scorch marks; this is simply discoloration of the residue in the towels themselves.
- The unit is constructed from extremely durable low carbon steel. To maintain a good appearance, follow these simple instructions:
- For routine cleaning, simply switch off the unit, allow to cool to room temperature, wipe with a damp cloth and buff with a soft, dry cloth.
- Under no circumstances should abrasive cleaners be used to clean the unit.
- If the product is damaged, do not repair by yourself, pls return to the maintenance center for repair.

SAVE THESE INSTRUCTIONS FOR HOUSEHOLD USE ONLY

INCLUDED COMPONENTS

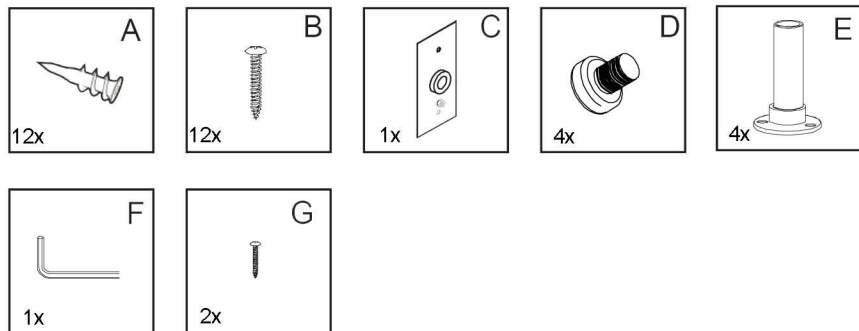

TOOLS REQUIRED

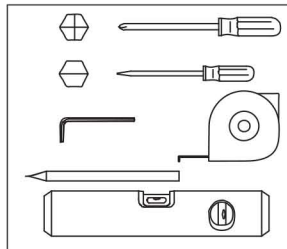

ELECTRICAL INFO

150 watts 1.3 amps 120 volts

WARRANTY

Two year limited warranty with proof of purchase will apply if all Terms and Conditions of Sale are met and Installation Instructions are adhered to.



FOR FULL WARRANTY VISIT:
www.ambaproducts.com/warranty

TRADITIONAL T-2536

INSTALLATION INSTRUCTIONS



PARAMETER

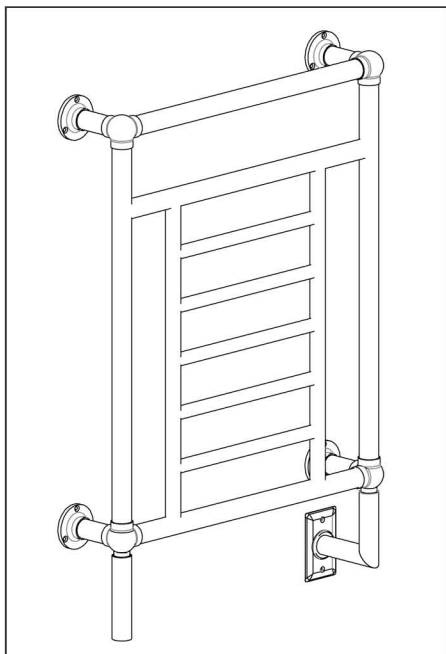

Intertek
500854
CONFORMS TO UL
STD.499
CERTIFIED TO CSA
STD C22.2 NO.64
Towel Warmer
Model: T-2536
Rated voltage: 120V~
Rated frequency: 60Hz
Rated power input: 150W
Serial No.: (周) XX/ (年) XX

Amba

CAUTION:
HOUSEHOLD USE ONLY
DO NOT IMMERSE IN WATER
HOT SURFACE
AVOID CONTACT
UTILISATION DU
MÉNAGE SEULEMENT
NE PAS PLONGER
DANS L'EAU SURFACE
CHAUDÉ ÉVITUE CONTACT

CONTACT

TEL:
404-3509738

FAX:
404-3550166

EMAIL:
customerservice@ambaproducts.com

WEB:
www.ambaproducts.com

AVAILABLE MODELS

T-2536 PN T-2536 BN

P-Polished Nickel B-Brushed Nickel

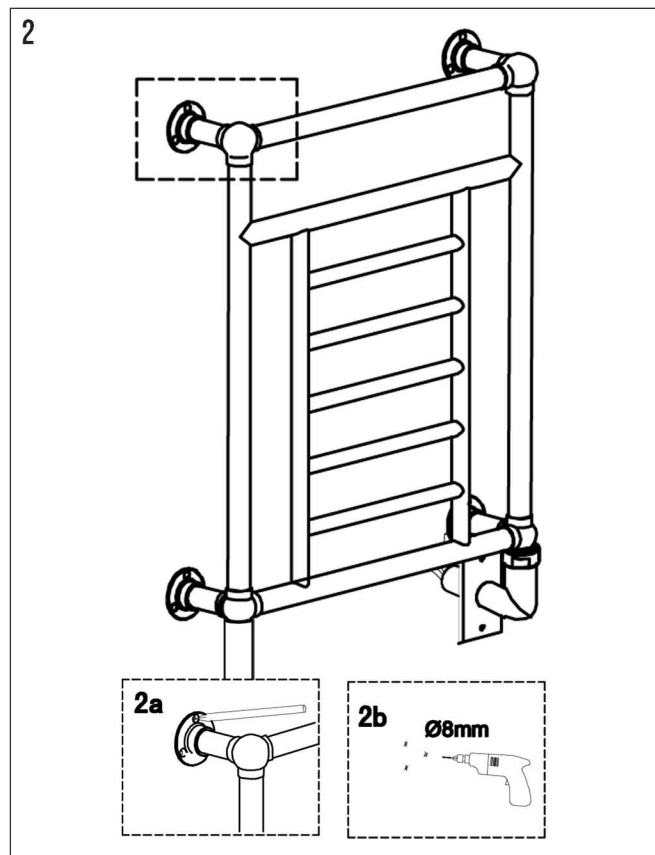
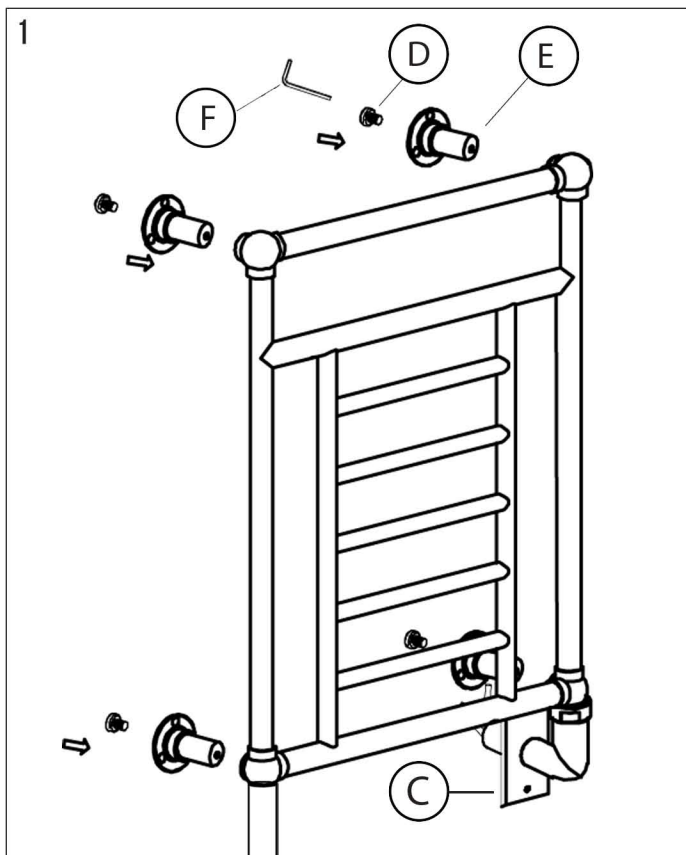

! CAUTION — SURFACE OF UNIT IS HOT WHEN ON !

TRADITIONAL T-2536

INSTALLATION INSTRUCTIONS

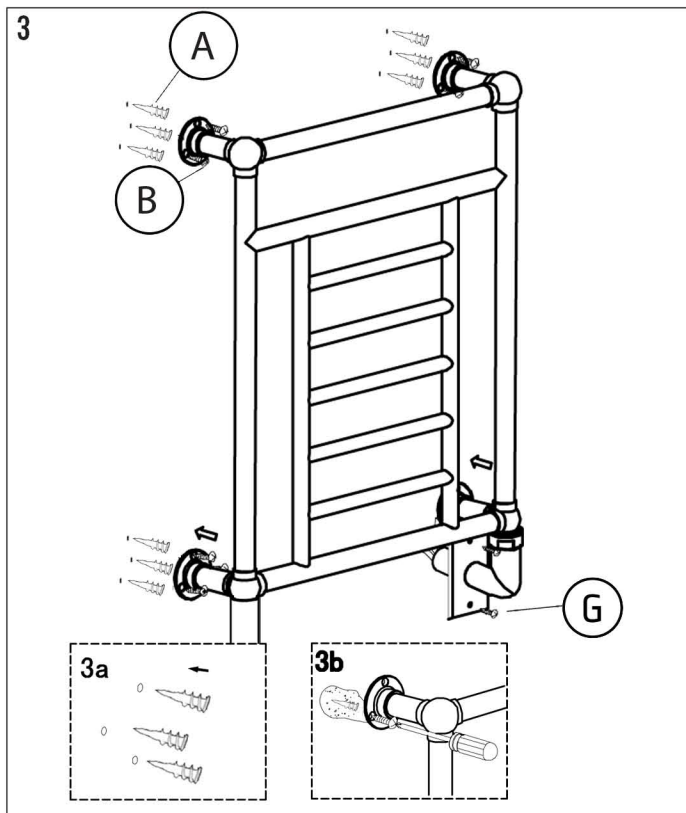

DO NOT OVER-TIGHTEN SET SCREW

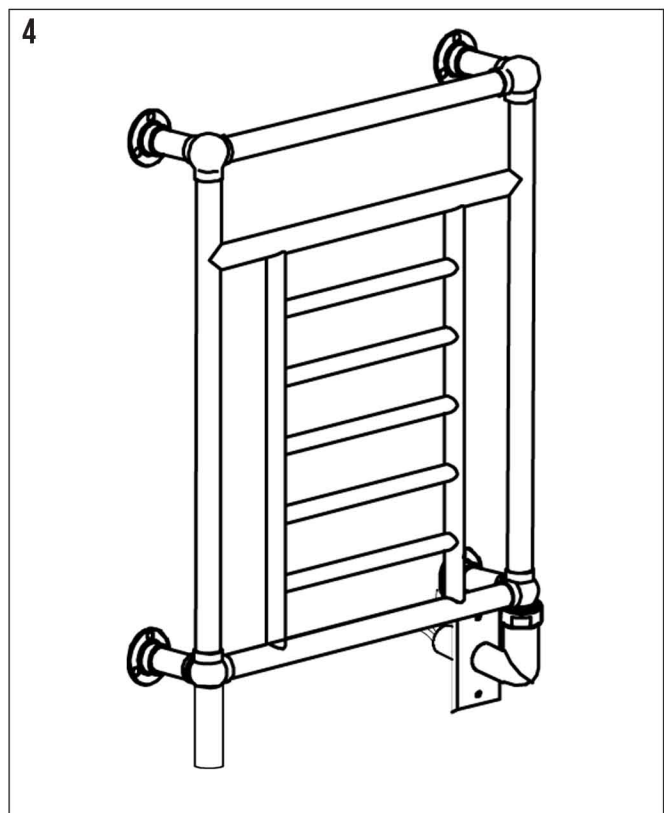

TURN UNIT ON WITH WALL SWITCH

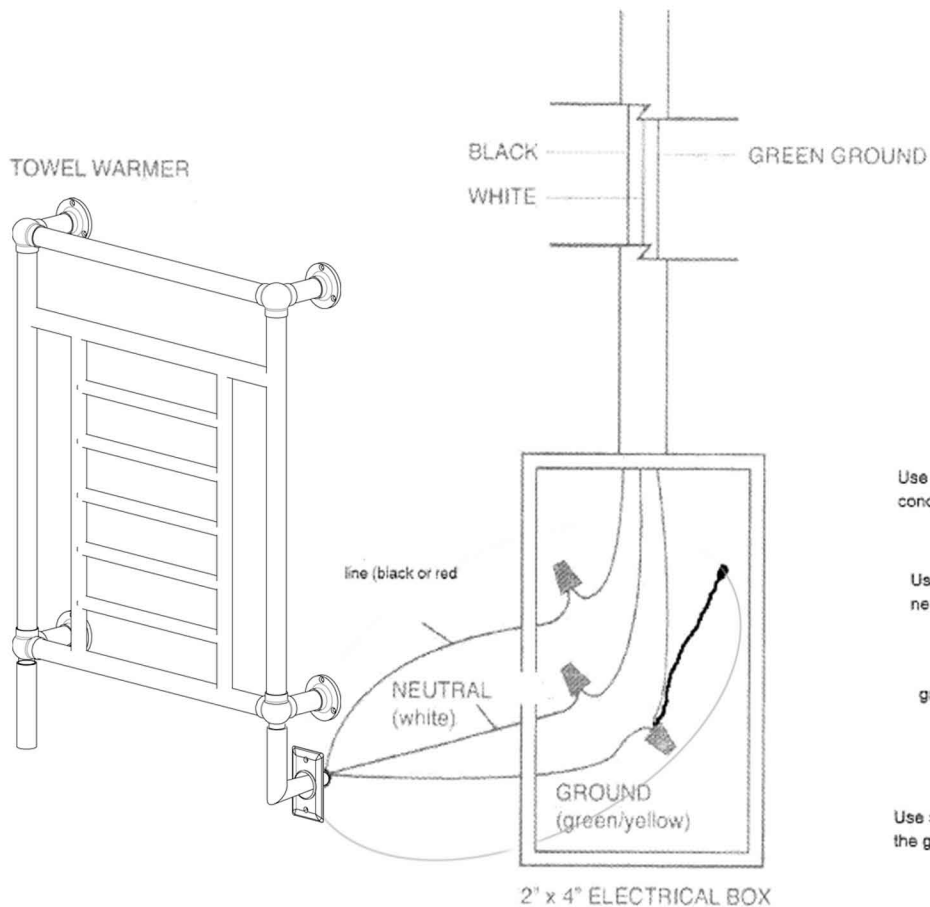

Use screw press cap to black or red lead to the line conductor of the fixed wiring

Use screw press cap to connect the white lead to the neutral conductor of fixed wiring

grounding wire fixed on the junction box cover

Use screw press cap to connect green/yellow lead to the green/yellow conductor of fixed wiring

! CAUTION — SURFACE OF UNIT IS HOT WHEN ON !

TRADITIONAL T-2536

INSTALLATION INSTRUCTIONS



Usage display

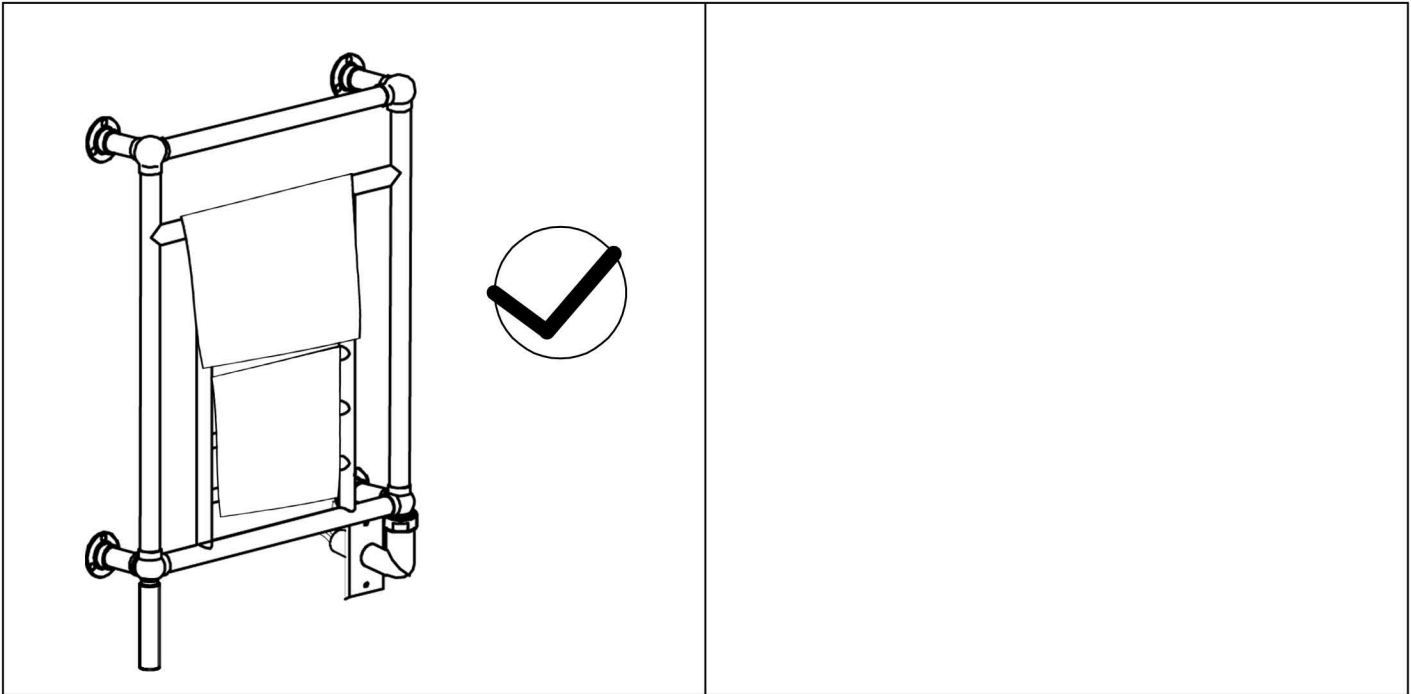

! CAUTION — SURFACE OF UNIT IS HOT WHEN ON !